

## Reset your password using the Mobile APP

“You will need to do the enrollment and register your mobile app before you are able to reset your network password”

1. Open the PortalGuard Password Reset app. Type in your new password, then press **Reset Password**.

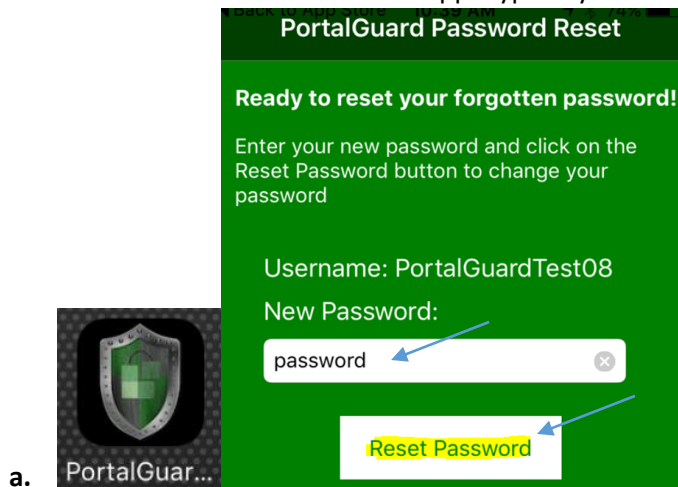

## Reset your password using the Web Browser

“You will need to do the enrollment before you are able to reset your network password”

1. Log into <https://password.pacollege.edu> , click on **Forgot Password?**
2. Enter your username and click continue.

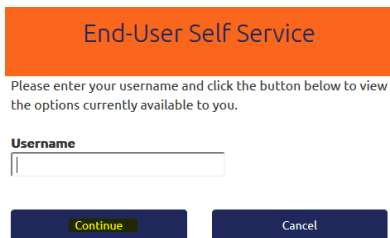

3. A One Time Password will be sent to your phone via text message. Enter in the OTP and click continue. You can also select the option to have the OTP send to your non-PA College email address.

